

NOTES

1. This drawing is to be read in conjunction with all other relevant drawings. Any discrepancies, errors or omissions to be brought to the attention of JBA.

2. All dimensions to be checked before commencement of work or production of shop drawings.

3. The drawings and written material herein constitute original work of JBA and as intellectual property and instruments of service, are subject to copyright and may not be reproduced, distributed, published in part or whole or used in any way without the express written consent of JBA.

- Element removed
- Foul Drainage Pipework
- Storm Drainage Pipework
- Steel Beam
- Structural Timber Beam
- Insulated Lintel
- Pre-cast Concrete Lintel

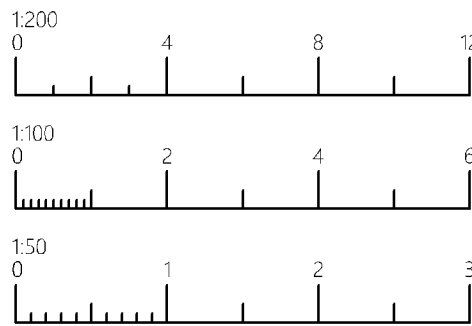

REVISION		
NO	DESCR.	DATE
A	- Client Amendments	06/03/24
B	- Client Amendments	12/03/24
C	- Client Amendments	03/07/24
D	- Client Amendments	23/08/24
E	- Client Amendments	18/10/24
F	- B. Reg Amendments	05/11/24
G	- Addition of engs. calcs	05/11/24
P2	- Phase 2 amends	25/06/25
P2A	- Phase 2 amends	11/07/2025
P2B	- Phase 2 amends	30/07/25

FOR CONSTRUCTION

INCEPTION DATE

05/02/2024

STAGE

Construction Drawing

SCALE

1:10, 1:50, 1:200

SHEET SIZE

A1

PROJECT BRIEF

Proposed single storey rear/side extension and internal alterations

SITE ADDRESS

Church Broughton Methodist Chapel
Chapel Lane,
Church Broughton,
DE65 5BB

CLIENT

Church Broughton Parish Council

PROJECT ID

23009

DRWG NO

C301

REV

P2B

2 BUILDING SECTION

SCALE: 1:50

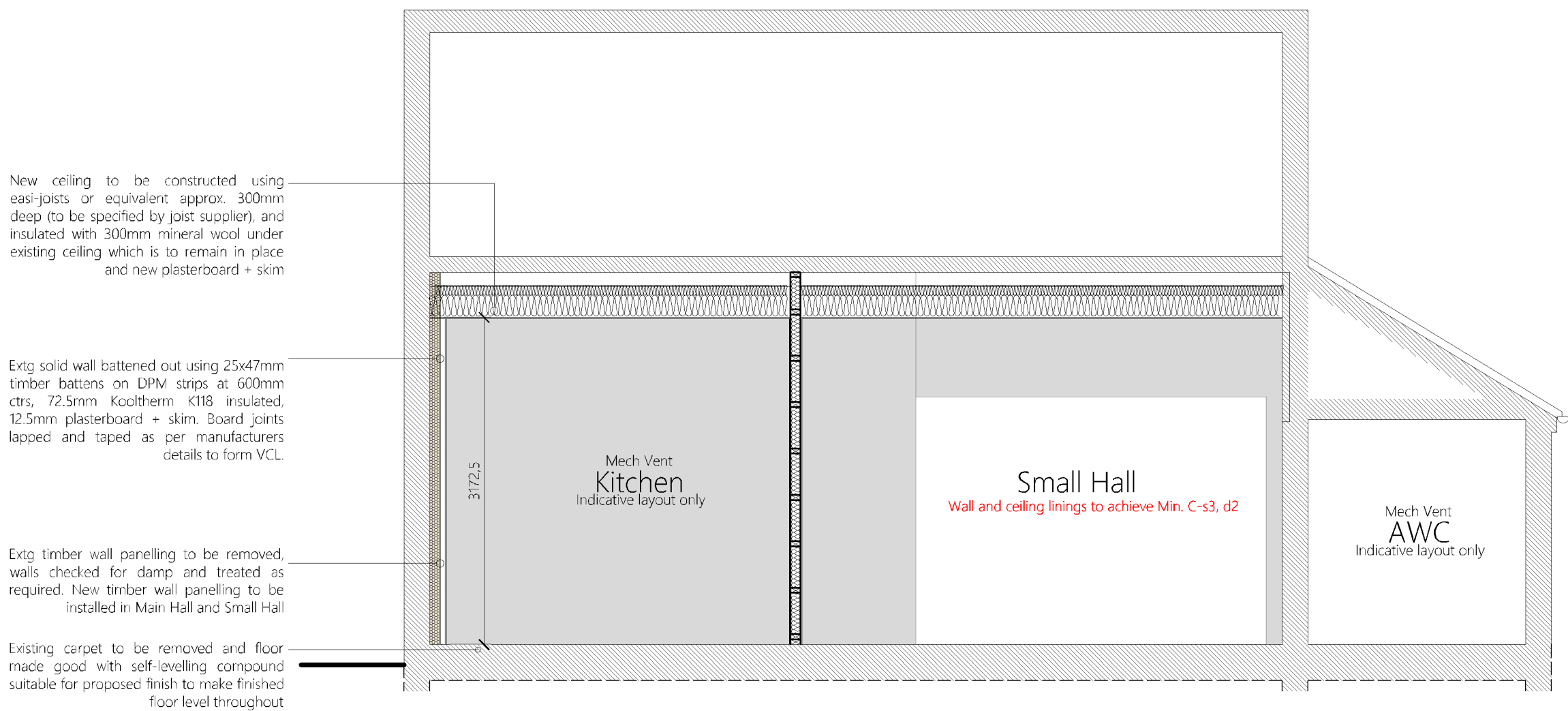

1 BUILDING SECTION

SCALE: 1:50



3 SITE PLAN

SCALE: 1:200

